



---

**Proposed disposal of a plot of land to the rear of number 65 Croydon Park Avenue,  
Marino, Dublin 3.**

---

An application has been received from Philip Doherty and Edel Egan to purchase a plot of ground to the rear of their property at No. 65 Croydon Park Avenue, Marino, Dublin 3. The plot of ground in question, which is shown coloured pink on Map Index No. SM-2016-0548 has been incorporated into their rear garden for many years.

It is proposed to dispose of the City Council's interest in the plot of ground to Philip Doherty and Edel Egan subject to the following terms and conditions:

1. The consideration shall be one thousand euro.
2. The purchaser shall be responsible for any costs involved in incorporating the plot into their garden.
3. As the property overlies the Port Tunnel any conveyance in respect of the property will exclude this substratum.
4. The purchaser shall be responsible for both their own and the Council's legal costs in the matter.

The property was acquired from Richard Corballis in 1927.

The disposal shall be subject to any such covenants and conditions as the Law Agent in his discretion shall stipulate.

No agreement enforceable at law is created or intended to be created until an exchange of contracts has taken place.

This proposal was approved by the North Central Area Committee at its meeting on 19<sup>th</sup> December 2016.

This report is submitted in accordance with the requirements of Section 183 of the Local Government Act, 2001.

Dated 20<sup>th</sup> day of December 2016.

**Paul Clegg**  
**Executive Manager**

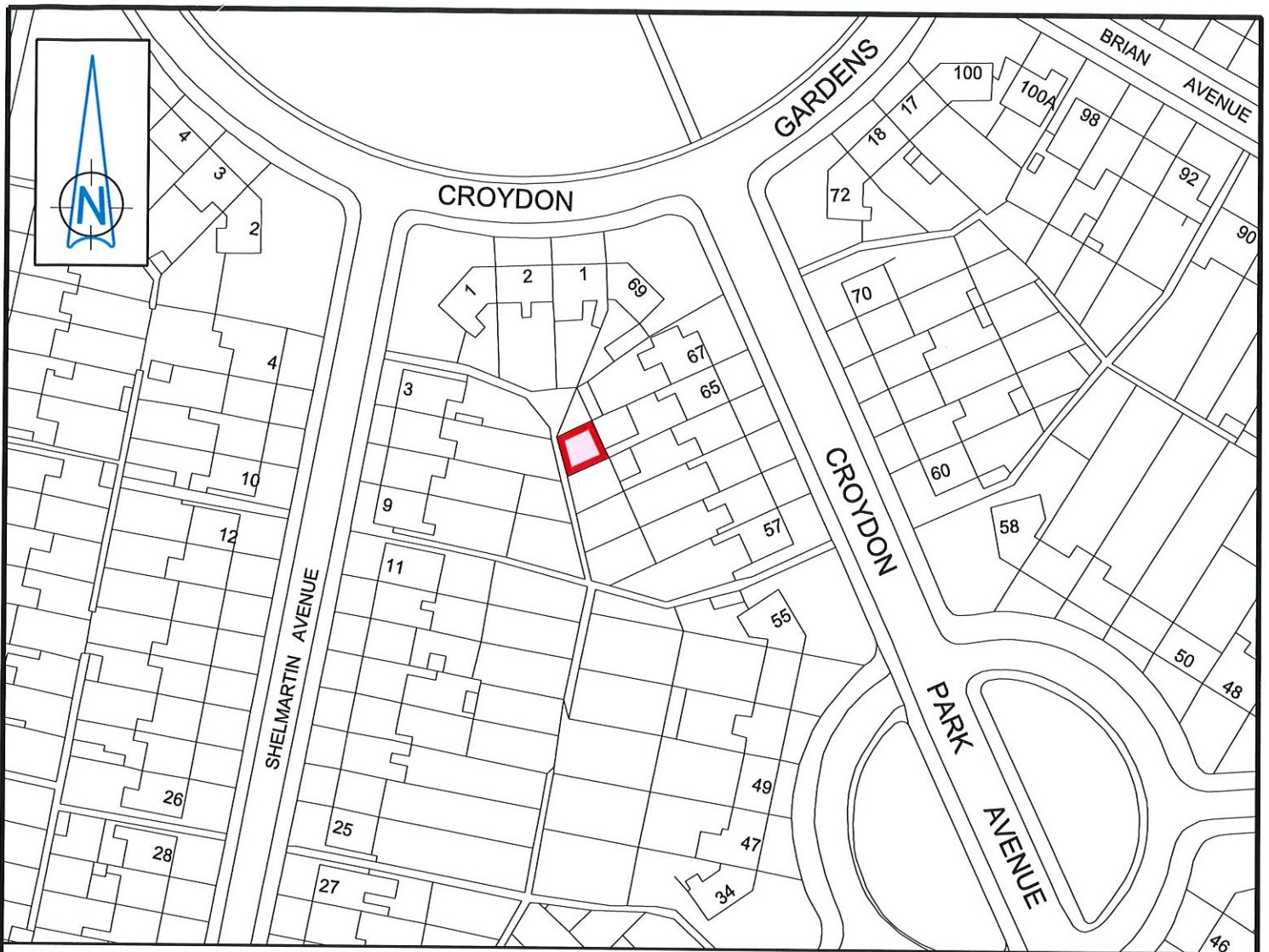

# CROYDON PARK AVENUE - No. 65

## Lands at rear

Dublin City Council to Philip Doherty and Edel Egan  
Disposal of Fee Simple

Area: 41.5m<sup>2</sup>

**NOTE: The entire area of this site forms part of the existing Dublin Port Tunnel - this substratum portion is excluded from the sale**



Comhairle Cathrach  
Bhaile Átha Cliath  
Dublin City Council

An Roinn Comhshaoil agus Iompair  
Rannán Suirbhéireachta agus Léarscáilithe  
Environment and Transportation Department  
Survey and Mapping Division

**O.S REF**

3198-07

**SCALE**

1:1000

**DATE**

16-11-2016

**SURVEYED /  
PRODUCED BY**

T. Curran

**JOHN W. FLANAGAN**  
PhD CEng Eur Ing FIEI FICE  
**ACTING CITY ENGINEER**

**FILE NO**

INDEX No

FOLDER  
No

CODE

DWG  
No

REV

SM-2016-0548-\_0204- C3 - 001 - A.dgn

THIS MAP IS CERTIFIED TO BE COMPUTER GENERATED BY  
DUBLIN CITY COUNCIL FROM ORDNANCE SURVEY DIGITAL MAPBASE

SURVEY, MAPPING AND RELATED RESEARCH APPROVED

APPROVED

**THOMAS CURRAN**  
ACTING MANAGER LAND SURVEYING & MAPPING  
DUBLIN CITY COUNCIL

**INDEX No.**

**SM-2016-0548**